

SECUNORM 500

UNMISTAKABLY PROFI. PERFECTLY REINVENTED.

NEW



ENJOY SAFETY
MADE IN SOLINGEN

martor

SECUNORM 500

NO. 50000110



Original size



Ergonomic handle

The good "Ergonomics" can be felt all over the SECUNORM 500, for example in the newly shaped handle which fits comfortably into the hand. Or in details such as the nicely rounded knife end or the non-slip soft-grip on the slider.



Abrasion resistant

The robust aluminium handle is designed for the most demanding and frequent cutting tasks. Like its popular predecessor, it is a tough all-rounder capable of taking on any cutting challenge.



Double-sided slider

With the predecessor, the SECUNORM PROFI, there were both left and right handed models. With the modern successor, anyone can cut effectively – with the ability to change hands when the task requires it.



Tool-less blade change

Blade changing without tools. The SECUNORM 500 comes with an intuitively operated blade change button. Press once to remove the blade carrier with its securely held blade.

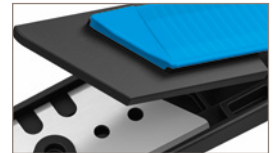

Blade changing made easy

The blade cover remains in the required position when opened. The blade is then easy to access and is removed using the bladeless edge, avoiding risk of injury.

The safety knife. With rounded-tip trapezoid blade.

Over 40 years ago the SECUNORM PROFI set standards in safety, robustness and ergonomics. Its successor goes several steps further. For example, the new aluminium handle significantly improves handling and makes cutting easier, the new slider can be operated from both sides and the blade change has been made so much simpler. Together these improvements combine with the proven automatic blade retraction to increase protection from cutting injuries.

PRODUCT FEATURES

Technical features

| | |
|---|--|
|  High safety |  Safer blade change (with magnet) |
|  Very abrasion resistant |  Very ergonomic |
|  2-cutting edge blade |  Cutting depth |
|  Rounded-tip trapezoid blade |  Soft grip |
|  Ceramic blade insertable |  For right and left handers |





Main cutting materials

| | |
|---|--|
|  Cardboard: up to 3-ply |  Wrapping, stretch, and shrink foil |
|  Plastic strapping band |  Tape |
|  Bagged goods |  Layers of foil or paper |

Installed blade

| | |
|--|--|
|  | NO. 65232 0.63 mm, rounded blade tips, deep-edged |
|--|--|

Optional blade

| | |
|--|---|
|  | NO. 65232C 0.65 mm, ceramic, rounded blade tips, deep-edged |
|  | NO. 5232 0.63 mm, deep-edged NO. 5233 0.63 mm, 1-sided ground-edge |
|  | NO. 610 0.63 mm, stainless NO. 852 0.63 mm, stainless, TiN-coated NO. 56 0.63 mm |
|  | NO. 5634 0.63 mm, rounded blade tips |

Certificates and awards



Application

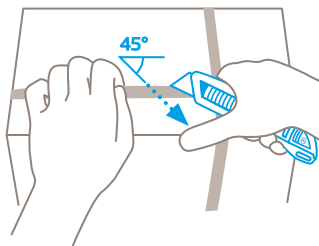
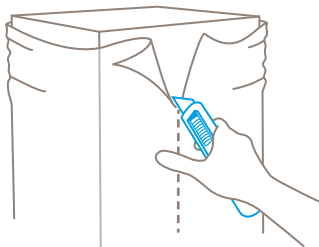
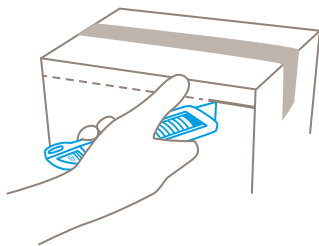

Safety technology

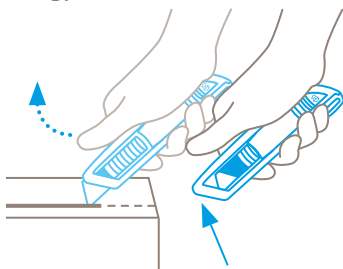

Automatic blade retraction – a high degree of safety





The automatic blade retraction of the SECUNORM 500 guarantees a high degree of safety from cut injuries. As soon as you have started to cut, take your thumb off the slider. Then the blade will retract into the handle immediately after leaving the material being cut.

THE PERFECT FIT FOR ALL. DOES THE PERFECT JOB.

SECUNORM 500

- › For high cutting frequencies
- › Ergonomic handle for left and right handers
- › Very abrasion proof thanks to the aluminium
- › Automatic blade retraction
- › GS-certified for approved safety

PRODUCT DETAILS

| | |
|--|--|
| Order No. | NO. 50000110.02 |
| Packaging unit | 1 in single unit box (10 in multipack) |
| Knife size (L x W x H) | 143 x 16 x 36 mm |
| Main material | Aluminium |
| Weight | 72.5 g |
| Cutting depth | 17 mm |
| Spare blade Packaging unit Size (L x W x Thickness) | NO. 65232.70 (10 in dispenser) 50.1 x 19 x 0.63 mm |
| Certified | GS certificate NO. 603574-6653-55094- 2018/2 |
| Accessories | |
| BELT HOLSTER S WITH CLIP |  NO. 9920 |
| HOLSTER SMALL |  NO. 9842 |
| USED BLADE CONTAINER |  NO. 9810 |
| WALL MOUNT BRACKET USED BLADE CONTAINER |  NO. 9845 |
| SAFEBOX |  NO. 108000 |

CONTACT AND SERVICE

What makes our cutting solutions even safer?
Our advisory services! We are always on hand,
to give advice, to provide you with training ma-
terial, to meet with you in person if necessary.

You will find further information on our website:
www.martor.com



At a glance: the safety poster shows the most important functions and correct usage – perfect for your workplace.



From the first cut to changing the blade, our video will show you the best way to use this knife.



Everything you want to know: dimensions, properties, special features and more about our cutting tools can be found in the Technical Data Sheet.



Still have questions? You can reach our service department on [+49 212 73870-0](tel:+49212738700)